

# REPLACEMENT PARTS SUITABLE FOR KJELLBERG®

PA-S20W™, PA-S25W™, PA-S40W™, PA-S45W™, PA-S70W™  
PB-S45W™

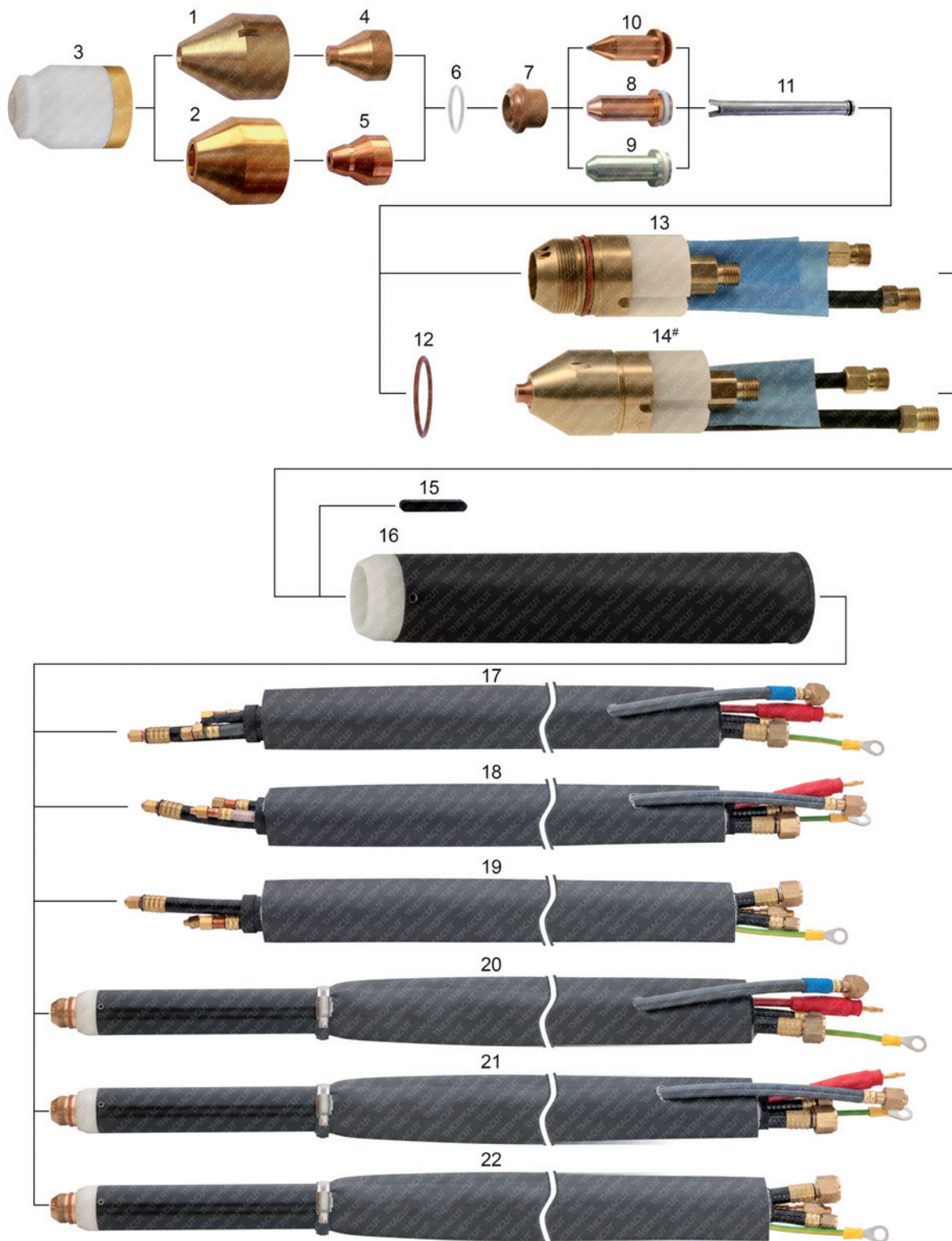

Last update of this page: 18/05/2017. See Revision history for details.

**THERMACUT®**  
THE CUTTING COMPANY

WWW.THERMACUT.CZ  
TEL.: +420 556 423 418  
SALES@THERMACUT.CZ

WWW.THERMACUT.DE  
TEL.: +49 (0) 27 39 40 33 0  
INFO@THERMACUT.DE

WWW.THERMACUT.COM  
TEL.: 1-603-542-6715  
CUSTOMERSERVICE@THERMACUT.COM

THERMACUT®, FHT-EX® AND EX-TRAFIRE® ARE REGISTERED TRADEMARKS OF THERMACUT, K. S. AND MAY BE REGISTERED IN CZECH REPUBLIC AND/OR OTHER COUNTRIES. ALL OTHER TRADEMARKS ARE PROPERTIES OF THEIR RESPECTIVE OWNERS. THERMACUT IS NO WAY AFFILIATED WITH KJELLBERG®. MOST THERMACUT PARTS ARE MADE FOR OR BY AN IBG COMPANY. PARTS INDICATED WITH A OEM ARE ORIGINAL PARTS MANUFACTURED BY THE ABOVE NAMED MANUFACTURER AND ARE BEING RESOLD BY THERMACUT. THERMACUT RESERVES THE RIGHT TO SUBSTITUTE OEM PARTS IN PLACE OF THERMACUT PARTS. VALID FROM MAY 2017 • PREVIOUS VERSION IS NO LONGER VALID. • © COPYRIGHT 2017 BY THERMACUT® CZECH REPUBLIC. ALL RIGHTS RESERVED.

# REPLACEMENT PARTS SUITABLE FOR KJELLBERG®

PA-S20W™, PA-S25W™, PA-S40W™, PA-S45W™, PA-S70W™  
PB-S45W™

Item	Part No.	Ref. No.	Sh.Ref.No.	Description	Std.Pkg.	Item	Part No.	Ref. No.	Sh.Ref.No.	Description	Std. Pkg.
1.	T-8609	11.828.201.151		Nose Cap 6,0	1	NS	T-8710	11.828.001.820 OEM		Cathode Tool	1
2.	T-8617	11.830.301.151		Nose Cap 9,6	1	NS	T-11572	11.828.001.810 OEM		Nose Cap Tool	1
3.	T-10040	11.828.101.160		Protection Cap, Hand	1	15.	PT-12482	11.828.201.250-3		Tube Pin	1
4.	T-8611	11.828.201.410	Ll	Nozzle 1,0mm, Air, 45A	5	16.	T-8610	11.828.201.250		Tube complete, incl.pos.15	1
	T-8612	11.828.201.413	Ld	Nozzle 1,3mm, Air, 90A	5	17.	KT-1068	11.832.521.701		Cable Leads 10m PB-S45W-1/O <sub>2</sub>	1
	T-8613	11.828.201.414	Le	Nozzle 1,4mm, Air, 120A	10		KT-1449	K.PB-S45W-1O2.15M.K		Cable Leads 15m PB-S45W-1/O <sub>2</sub>	1
5.	T-8614	11.828.203.410	Lle	Nozzle 1,0mm, lle, Air, 45A	10	18.	KT-1468	11.832.501.701		Cable Leads 10m PB-S45W-1/L	1
	T-8615	11.828.203.413	Lde	Nozzle 1,3mm, Lde, Air, 90A	10		KT-1373	K.PB-S45W-1L.15M.K		Cable Leads 15m PB-S45W-1/L	1
	T-8616	11.828.203.414	Lee	Nozzle 1,4mm, Lee, Air, 130A	10	19.	KT-1473	11.831.601.700		Cable Leads 6m PB-S45WH/L	1
	T-8736	11.828.213.613	Ade	Nozzle, 1,3mm ArH <sub>2</sub> , 80A	10		KT-1296	11.832.401.701		Cable Leads 10m PB-S45W/L	1
	T-8737	11.828.213.614	Aee	Nozzle, 1,4mm ArH <sub>2</sub> , 100A	5		KT-1322	K.PB-S45W-L.15M.K		Cable Leads 15m PB-S45W/L	1
	T-8738	11.828.213.616	Afe	Nozzle, 1,6mm ArH <sub>2</sub> , 130A	5	20.	KT-1208	11.832.521.006		Torch with Leads 6m PB-S45W-1/O <sub>2</sub>	1
	T-8620	11.834.321.410	Lle-XL	Nozzle 1,0 45A O <sub>2</sub>	10		KT-1255	11.832.521.010		Torch with Leads 10m PB-S45W-1/O <sub>2</sub>	1
	T-8621	11.834.321.413	Lde-XL	Nozzle 1,3 90A O <sub>2</sub>	10		KT-1490	K.PB-S45W-1LO2.15M		Torch with Leads 15m PB-S45W-1/O <sub>2</sub>	1
	T-8622	11.834.321.414	Lee-XL	Nozzle 1,4 130A O <sub>2</sub>	10	21.	KT-1413	11.832.501.006		Torch with Leads 6m PB-S45W-1/L	1
6.	T-8601	10.575.036		O-Ring	1		KT-1254	11.832.501.010		Torch with Leads 10m PB-S45W-1/L	1
7.	T-8604	11.828.001.153	Z111	Swirl Ring	1		KT-1272	K.PB-S45W-1L.15M		Torch with Leads 15m PB-S45W-1/L	1
	T-10794	11.828.001.153K	Z111	Swirl Ring, Ceramic	1		KT-1230	11.832.501.1015		Torch with Leads 1,5m PB-S45W-1/L	1
8.	T-8605	11.828.001.3001	Kb	Cathode	5	22.	KT-1402	11.832.401.006		Torch with Leads 6m PB-S45W/L	1
9.	T-4921	11.834.321.3001-AG		Cathode, SilverEX®	5		KT-1116	11.832.401.010		Torch with Leads 10m PB-S45W/L	1
10.	T-8735	11.828.211.5001	Ka	Cathode ArH <sub>2</sub> (i)	5		KT-1054	K.PB-S45W-L.15M		Torch with Leads 15m PB-S45W/L	1
11.	T-8603	11.828.001.152		Cooling Tube	1		KT-1356	K.PB-S45W-L.20M		Torch with Leads 20m PB-S45W/L	1
12.	T-8602	10.575.052		O-Ring	1	NS	KT-1417	K.PB-S45W-1L-O <sub>2</sub> .20M		Torch with Leads 20m PB-S45W/L-1/O <sub>2</sub>	1
13.	T-8926	11.828.301.100		Torch Body, Machine	1		Different types of cable leads available on request				
#14.	T-8607#	11.828.201.100		Complete Torch, Machine	1						

(i) THIS PART MAY NOT BE DISTRIBUTED ON THE GERMAN MARKET. THERMACUT ACCEPTS NO RESPONSIBILITY IN CASE OF INDIRECT SALES TO GERMANY.

# INCLUDING PARTS: TORCH 11.828.301.100, ELECTRODE 11.828.001.3001, SWIRL RING 11.828.001.153, O-RING 10.575.036, NOZZLE 11.828.203.413, NOSE CAP 11.830.301.151

NS NOT SHOWN IN THE PICTURE

**Last update of this page: 18/05/2017. See Revision history for details.**

**THERMACUT®**  
THE CUTTING COMPANY

WWW.THERMACUT.CZ  
TEL.: +420.556.423.418  
SALES@THERMACUT.CZ

WWW.THERMACUT.DE  
TEL.: +49 (0) 27 39 40 33 0  
INFO@THERMACUT.DE

WWW.THERMACUT.COM  
TEL.: 1-603-542-6715  
CUSTOMERSERVICE@THERMACUT.COM

THERMACUT®, FHT-EX® AND EX-TRAFIRE® ARE REGISTERED TRADEMARKS OF THERMACUT, K. S. AND MAY BE REGISTERED IN CZECH REPUBLIC AND/OR OTHER COUNTRIES. ALL OTHER TRADEMARKS ARE PROPERTIES OF THEIR RESPECTIVE OWNERS. THERMACUT IS NO WAY AFFILIATED WITH KJELLBERG®. MOST THERMACUT PARTS ARE MADE FOR OR BY AN IBG COMPANY. PARTS INDICATED WITH A OEM ARE ORIGINAL PARTS MANUFACTURED BY THE ABOVE NAMED MANUFACTURER AND ARE BEING RESOLD BY THERMACUT. THERMACUT RESERVES THE RIGHT TO SUBSTITUTE OEM PARTS IN PLACE OF THERMACUT PARTS. VALID FROM MAY 2017 • PREVIOUS VERSION IS NO LONGER VALID. © COPYRIGHT 2017 BY THERMACUT® CZECH REPUBLIC. ALL RIGHTS RESERVED.